

Instruction manual

1. Placement product

Place the product horizontally and turn the product handle to the disconnect position.

2. Mounting support base

Adjust the position of the support turntable so that it is in line with the product handle and cover the support base.

3. Mounting support frame (U-Shaped)

Push the U-shaped support frame into the product and move it to the mounting slot at the bottom of the product.

4. Screw fastening

Fasten the bracket cover and tighten the setting screws(The torque of the electric screwdriver should be $1.0N \cdot m$).

-01-

5. Fixed product

Select the appropriate size of the box and the installation method to fix the product, install and fix the handle and connecting rod according to the requirements of the diagram.

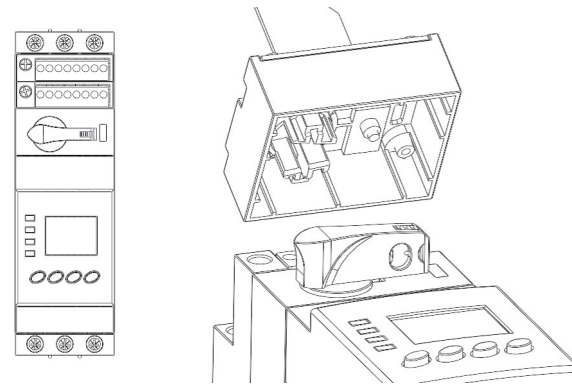

-02-

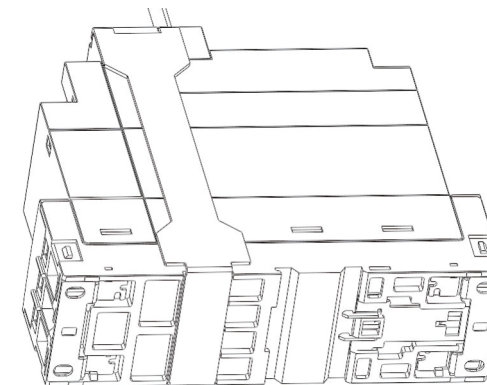
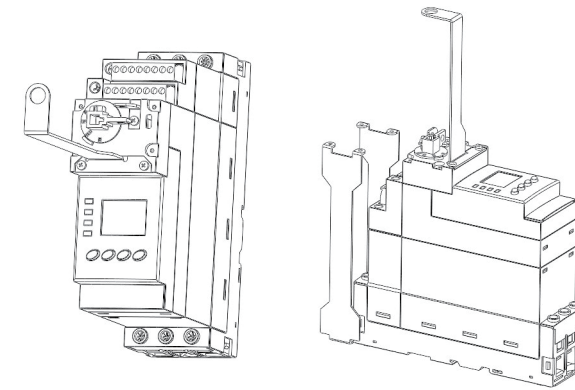

-03-

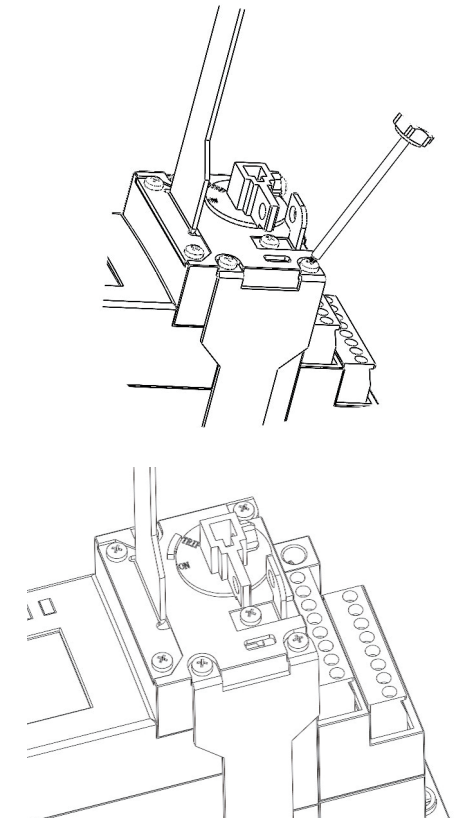

-04-

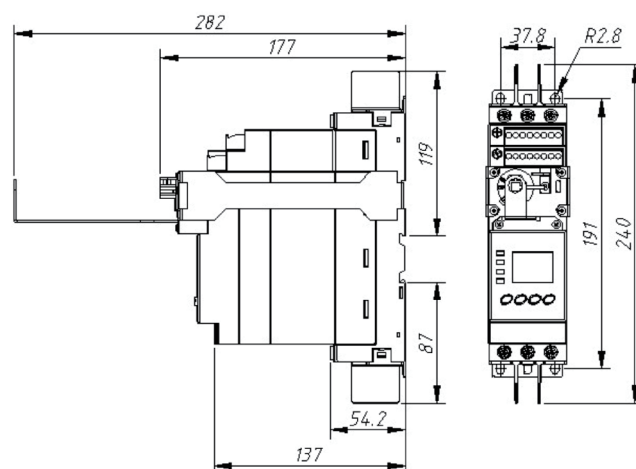

Mount with "TH35" standard guide rail or screw(M5)

-05-

Example

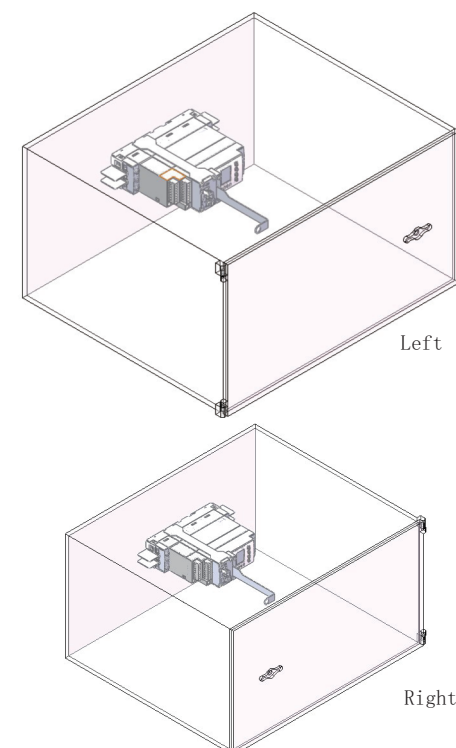

-06-

Optional installation method

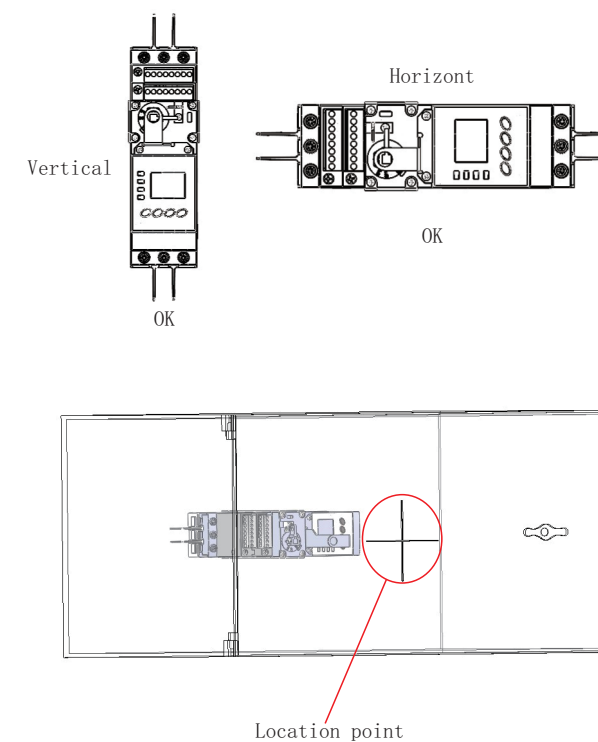

-07-

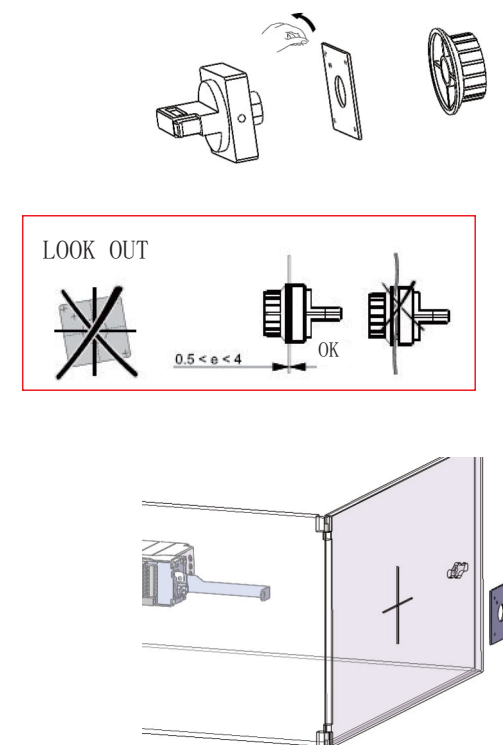

-08-

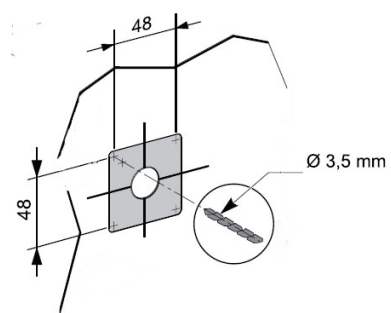
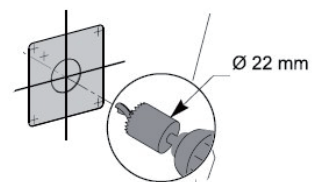
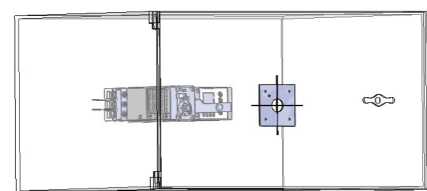

-09-

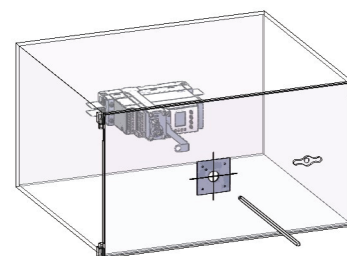

LOOK OUT

Keep the product in the same center as the operating handle and connecting rod.

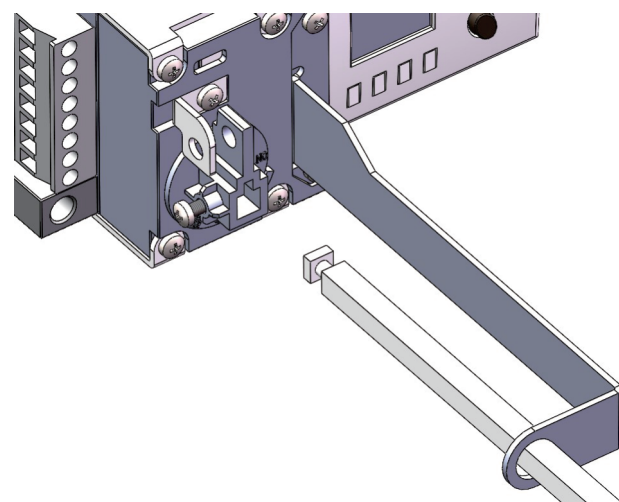

-10-

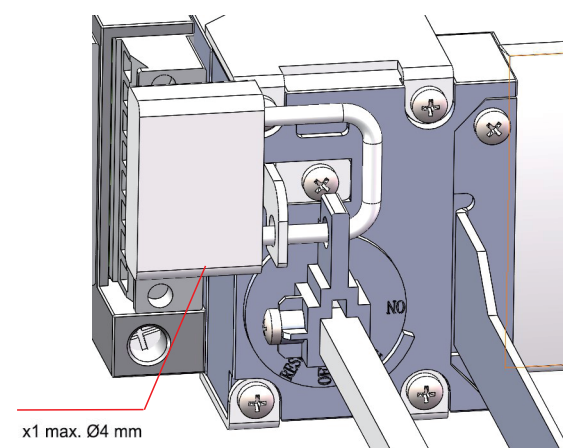
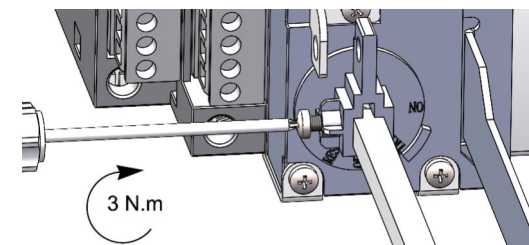

-11-

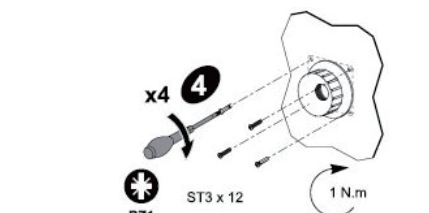
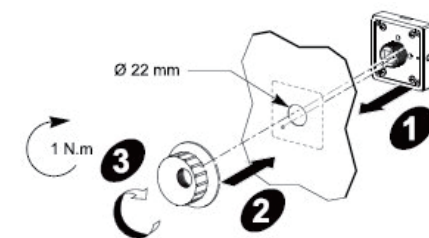
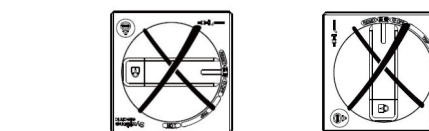
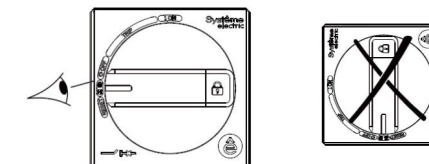

-12-

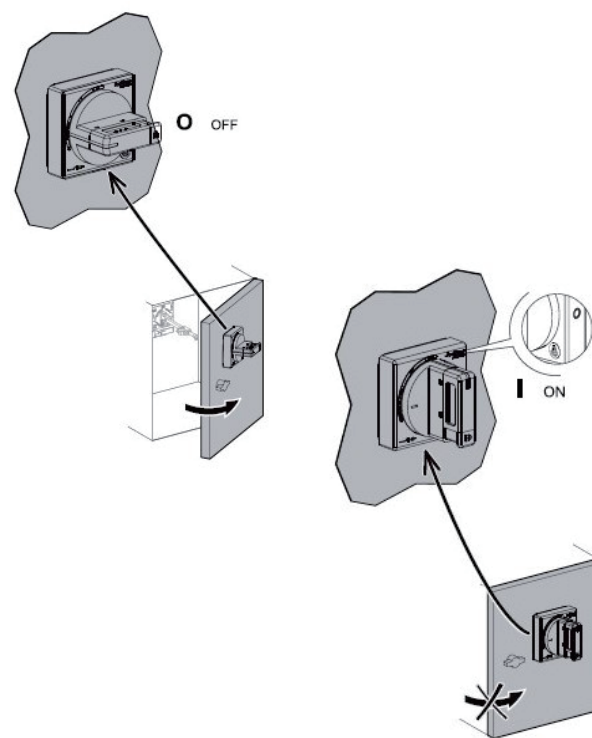

-13-

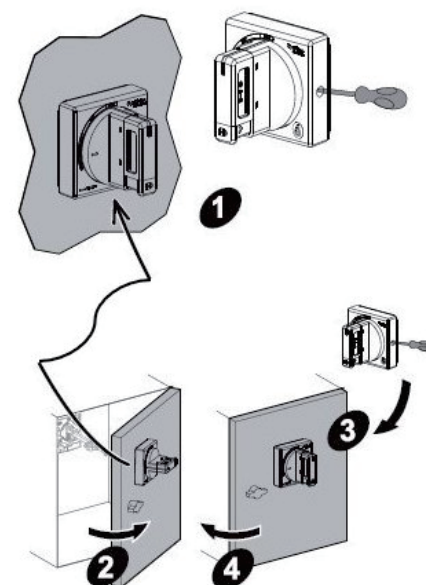

-14-

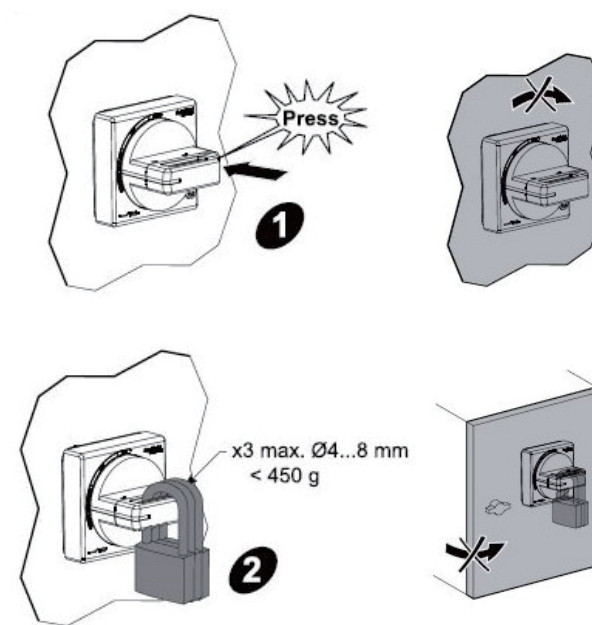

-15-

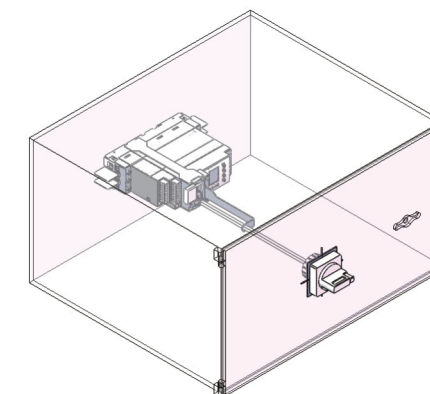

-16-